



20 Kanimbla Crescent Craigmore SA

3 1 6

Kelly Hooper & Trinity Property Group welcome you to 20 Kanimbla Crescent, Craigmore - a well-maintained home that is situated in a prime, family-friendly location and close to all the amenities you could as for. Along with being positioned on a large 616sqm allotment, this home offers a sensational opportunity for first home buyers, families or investors looking to expand their portfolio - you are sure to love this one from the moment you step inside!

Upon entering the home, you'll be greeted by the spacious lounge room, which is bright, white and sets the tone throughout the home. The versatile floor plan then leads you through to the open plan kitchen & meals area - offering an abundance of cupboard storage, double stainless-steel sink, electric oven/gas cook top, built-in

Type : House
Price : \$ 415,000
Land Size : 616 sqm
View : <https://www.trinitypropertygroupsa.com/sale/sa/north-north-east-suburbs/craigmore/residential/house/7148003>



Kelly Hooper
08 8251 5222

[For full version visit the website](https://www.trinitypropertygroupsa.com)

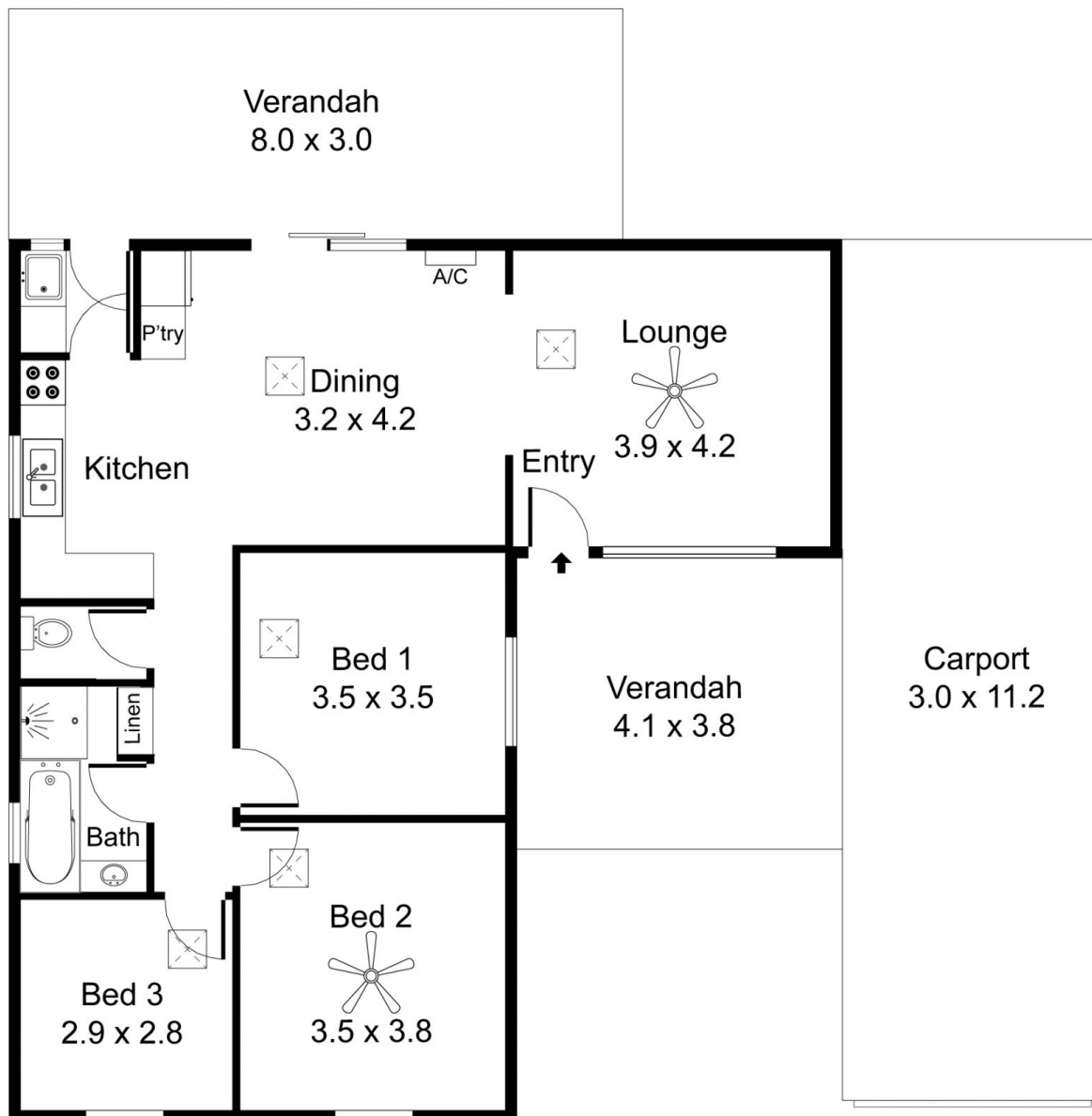

Photography & Floorplan by
www.m21studios.com.au

20 Kanimbla Crescent, Craigmore

DISCLAIMER: PLANS SHOWN ARE FOR PRESENTATION PURPOSES AND ARE NOT PART OF ANY LEGAL DOCUMENT. ALL MEASUREMENTS AND FIGURES ARE APPROXIMATE.